

ELEVATION VIEW

PROFILE VIEW

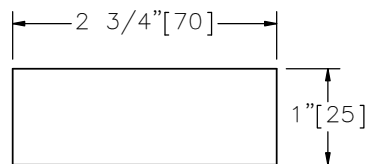

ELEVATION VIEW

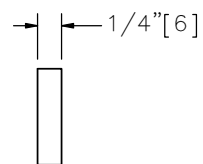

PROFILE VIEW

Post Standoff

## POST AND STANDOFF FOR WEAK-POST IN SOCKET



**PSF01**

SHEET NO.

DATE:

1 of 2

9/13/2016

## SPECIFICATIONS

This post shall be manufactured using galvanized ASTM A992 Grade 50 Steel. The section shall be manufactured such that it conforms to the geometry and tolerances of ASTM A992 for an S3x5.7 [S75x8.5] S-section. After all punching, drilling, stamping and welding is complete, the section shall be zinc-coated according to ASTM A123 (ASHTO M111). All holes shall be punched through both flanges (in-line).

Designator	Area in. <sup>2</sup> [10 <sup>3</sup> mm <sup>2</sup> ]	I <sub>x</sub> in. <sup>4</sup> [10 <sup>6</sup> mm <sup>4</sup> ]	I <sub>y</sub> in. <sup>4</sup> [10 <sup>6</sup> mm <sup>4</sup> ]	S <sub>x</sub> in. <sup>3</sup> [10 <sup>3</sup> mm <sup>3</sup> ]	S <sub>y</sub> in. <sup>3</sup> [10 <sup>3</sup> mm <sup>3</sup> ]
PSF01	1.67 [1.08]	2.52 [1.05]	0.455 [0.189]	1.68 [27.5]	0.391 [6.41]

Dimensional tolerances not shown or implied are intended to be those consistent with the proper functioning of the part, including its appearance and accepted manufacturing practices.

## INTENDED USE

The Post and Standoff assembly (PSF01) is designed to be used with MGS Bridge Rail (SBO02c), Top-Mounted Weak-Post Guardrail System Attached to Culvert (SGR52), and Side-Mounted Weak-Post Guardrail System Attached to Culvert (SGR53).

## CONTACT INFORMATION

Midwest Roadside Safety Facility  
University of Nebraska-Lincoln  
130 Whittier Research Center  
2200 Vine Street  
Lincoln, NE 68583-0853  
(402) 472-0965  
Email: [mwrfsf@unl.edu](mailto:mwrfsf@unl.edu)  
Website: <http://mwrfsf.unl.edu/>

## POST AND STANDOFF FOR WEAK-POST IN SOCKET



PSF01

SHEET NO.

2 of 2

DATE:

9/13/2016